

CLOVER

轻油燃烧器 Light Oil Burner

◆产品概述 Products Summarization

BT系列燃烧器是采用当今世界先进的燃烧技术，参照EN267标准和国家标准制造的机电一体化全自动轻油燃烧器，广泛用于蒸汽锅炉、热水锅炉、导热油炉、直燃式溴化锂空调机组、热发生器及其它工业加热、烘干炉设备。

The BT series burners, the Mechanical & Electrical Integration light oil burners which extensive use the steam boilers, heating water boilers, heat conducting oil stove, direct-fired generator, lithium bromide air-conditioning plant and other industrial heating and parch stove equipments, are designed by advanced combustion technology in the world and consult the EN267 Standard and the national interrelated standard.

◆性能特点 Performance feature

- 强制通风一体式
- 全自动操作
- 手动一段火/二段火转换开关
- 点火前对炉膛进行预吹扫
- 安全的火焰监测系统
- 燃烧器停机时，风门自动关闭（单段为手动调节风门）
- 安装、调试及保养方便
- 燃烧器机体轻巧，安装简易，用户只需接通电源及燃料即可以使用
- 运转噪音声小，烟气排放符合环保要求
- 适用轻油粘度在20°C时为6mm²/s(1.5°E)

◆IP40电气保护等级

*AI-in-one Blower.

*Auto-operation

*Manual switch for one stage/two stage

*Sweep the tube before ignition.

*Safety flame monitors system.

*The air gate will close automatic when the burner stop running. (manual adjust the air gate for one stage)

*It's Convenient for the installation, commissioning and maintenance.

*The burner is easy to install for the portable body. The client just connects the power supply and gas supply then can start the burner.

*The little running noise and the discharge gas can suitable for the demands of the environmental protection.

◆操作模式 Operation

*The standard collocate Electric protect grade is IP40.

BT...LF	On-off	手动调节风门-单段火
BT14-120LRF	HI-LOW with hydraulic system	液压式控制风门-两段火
BT180-350LRF	HI-LOW with servo motor	伺服马达控制风门-两段火
BT450-1000L S/M	Sliding/Modulating with servo motor	伺服马达控制风门-平滑/比例式

◆单段(耐高温型) One Stage (Refractory style)



技术数据 / Technical data

型号 Model	最大输出 Output max.		最小输出 Output min.		最大流量 Flow rate max.	最小流量 Flow rate min.	电源 Power supply	马达 Motor	包装尺寸 Packing Size	重量 weight
	KW	Kcal/h×10 ³	KW	Kcal/h×10 ³	Kg/h	Kg/h				
BT-K10KLF	119	10	59	5	10	5	230V/50Hz	0.11	450×340×270	12.5
BT-M8SLF	95	8	47	4	8	4		0.11	400×360×250	10
BT-M12SLF	140	12	70	6	12	6		0.13	400×360×250	12

◆单段 One-Stage



技术数据 / Technical data

型号 Model	最大输出 Output max.		最小输出 Output min.		最大流量 Flow rate max.	最小流量 Flow rate min.	电源 Power supply	马达 Motor	包装尺寸 Packing Size	重量 weight	
	KW	Kcal/h×10 ³	KW	Kcal/h×10 ³	Kg/h	Kg/h					
BT3LF	42.7	3	8	0.65	3	0.65	230V/50Hz	0.09	490×300×320	10	
BT6LF	74.3	6	31.9	2.75	6	3		0.11	490×300×320	12	
BT10LF	118	10	60	5	10	5		0.11	490×300×320	12	
BT14LF	172	14	89	7.5	14	7.5		0.15	470×455×340	15	
BT14LFW*	172	14	89	7.5	14	7.5		0.15	480×455×340	17.5	
BT18LF	213	18	90	8	18	8		0.37	650×520×385	23	
BT26LF	308	26	154	13	26	13		0.37	650×520×385	23	
BT35LF	391	34	178	15	34	15		0.37	805×525×405	26	
BT40LF	474	40	237	20	40	20		380V/50Hz	0.37	1100×600×450	54

*带防水罩 With waterproof cover

www.clover-incinerator.com

◆两段 Two-Stage



技术数据 /Technical data

型号 Model	最大输出 Output max.		最小输出 Output min.		最大流量 Flow rate max.		最小流量 Flow rate min.		电源 Power supply V	马达 Motor KW	包装尺寸 Packing Size L×P×H mm	重量 weight Kg
	KW	Kcal/h×10 ⁴	KW	Kcal/h×10 ⁴	Kg/h	Kg/h	Kg/h	Kg/h				
BT14LRF	172	14	89	7.5	14	7.5			230V/50Hz	0.15	470×455×340	16
BT14LRFW*	172	14	89	7.5	14	7.5				0.15	480×455×340	18
BT26LRF	308	26	154	13	26	13				0.37	740×520×380	30
BT35LRF	391	34	178	15	34	15				0.37	805×520×405	32
BT34LRF	355	34	155	13	34	13				0.37	805×520×405	32
BT40LRF	534	42	237	20	42	20				0.37	905×520×405	57
BT55LRF	652	55	332	28	55	28				1.1	1100×600×450	66
BT75LRF	889	75	415	35	75	35				1.1	1250×700×520	70
BT100LRF	1186	100	533	45	100	45				1.5	1350×700×550	91
BT120LRF	1660	130	474	40	130	40				2.2	1350×700×550	150
BT120LRF	2135	180	712	61	180	61			3	1350×700×550	180	
BT180LRF	3186	240	873	75	240	75			7.5	1400×800×620	225	
BT250LRF	3854	320	1304	110	320	110			7.5	1600×1030×800	265	
BT300LRF	4151	360	1364	120	360	120			9	1600×1030×800	310	

*带防水罩 with waterproof cover

2000×1030×800

2160×1200×950

◆平滑/比例式 Sliding/Modulating

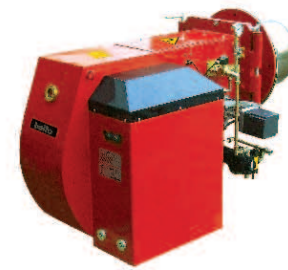

技术数据 /Technical data

型号 Model	最大输出 Output max.		最小输出 Output min.		最大流量 Flow rate max.		最小流量 Flow rate min.		电源 Power supply V	马达 Motor KW	包装尺寸 Packing Size L×P×H mm	重量 weight Kg
	KW	Kcal/h×10 ⁴	KW	Kcal/h×10 ⁴	Kg/h	Kg/h	Kg/h	Kg/h				
BT450LS/M	3810	330	715	60	320		60		380V/50Hz	9	1600×1100×850	208
BT550LS/M	6170	531	1130	97	518		95			13.5	1700×1250×850	210
BT650LS/M	8750	750	1905	164	735		160			18.5	2000×1300×1300	350
BT1000LS/M	10900	940	1905	164	915		160			22	2000×1300×1300	360

◆整体尺寸 Overall Dimensions

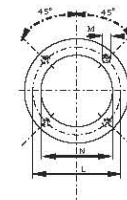
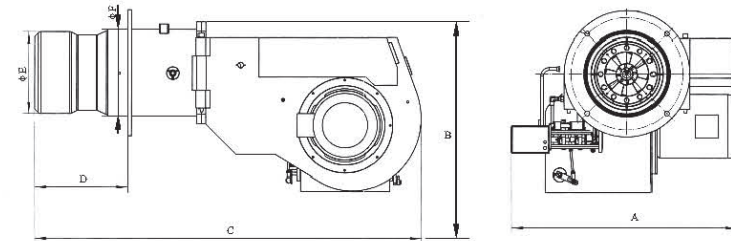

NO.1

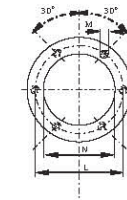

NO.2

型号 Model	A 克 Width mm	B 高 Height mm	C 长 Length mm	D 筒长 Length of blast tube mm	E 头 Head diameter mm	F 筒 Cylinder diameter mm	L安装孔尺寸 mm The size between the installation holes			N mm	M	NO.
BT450LS/M	962	740	1200	335	290	320	400			330	M16	1
BT550LS/M	965	780	1260	390	350	380	480			390	M16	1
BT650LS/M	1125	1075	1647	420	480	470	550			500	M16	2
BT1000LS/M	1230	1094	1670	430	480	470	550			500	M16	2

*N值为炉壁开口 N'means the size of the hole on the chamber.

◆单/两段式工作范围 Curve Diagram

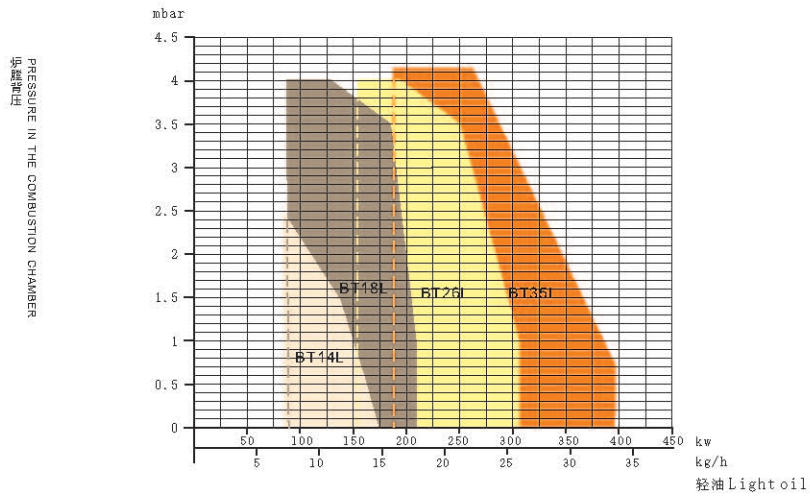
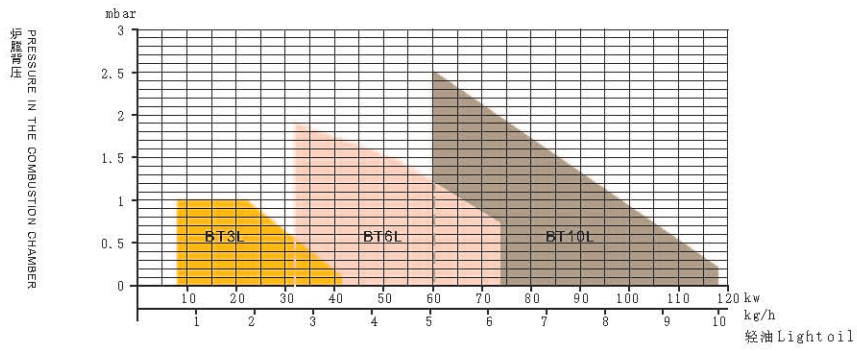
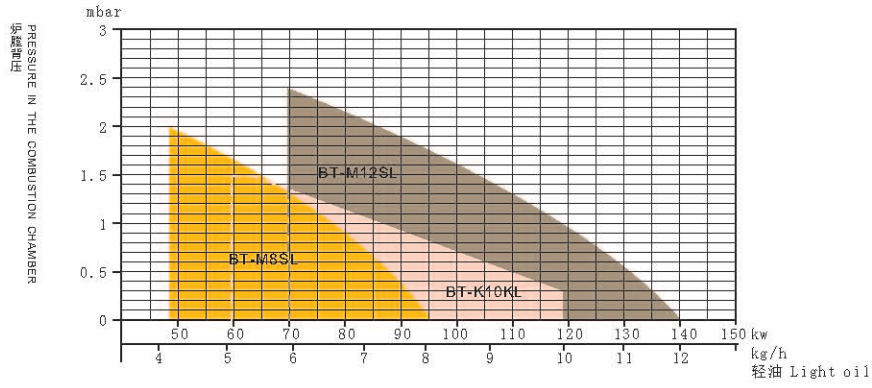

www.clover-incinerator.com

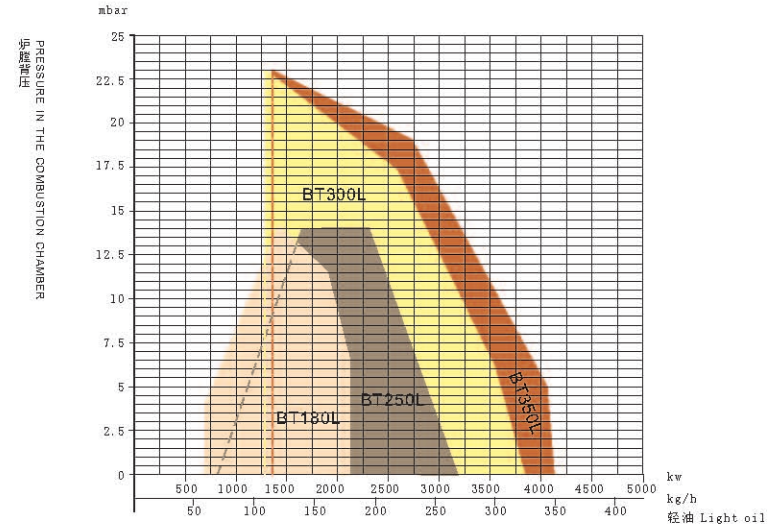
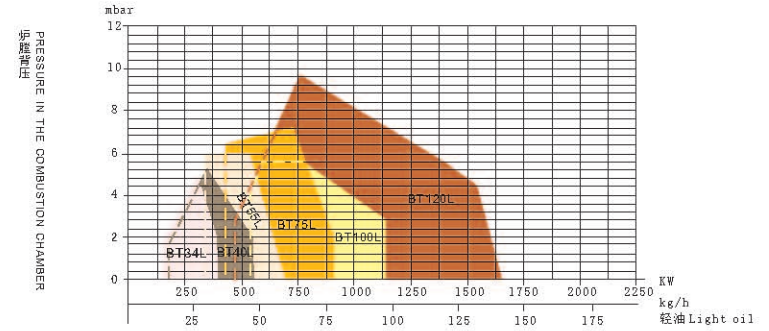

◆平滑/比例式工作范围 Sliding/Modulating curve diagram

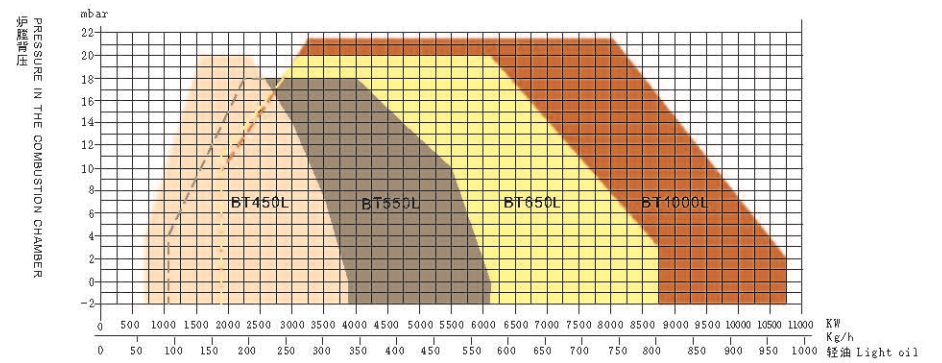

◆整体尺寸 Overall Dimensions

BT-K10K, M8S, M12S, 14L

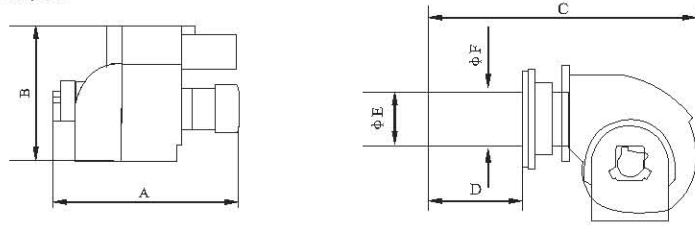

BT3L, 6L, 10L

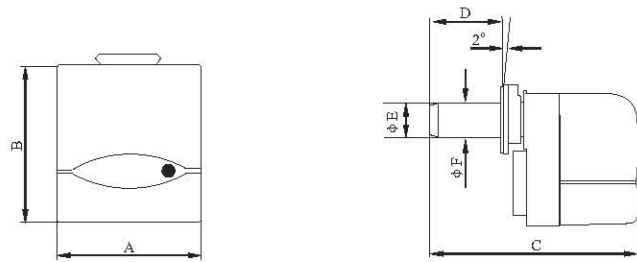

BT18L, 26L, 35L

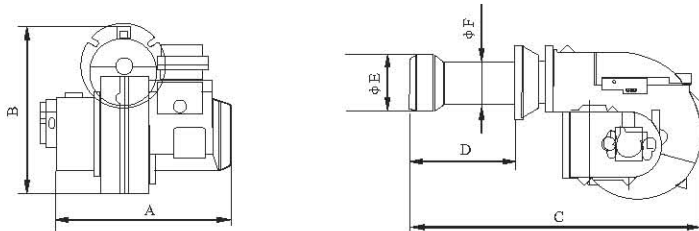

BT34L, 40L, 55L, 75L, 100L, 120L, 180L, 250L, 300L, 350L

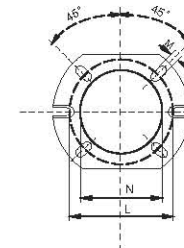
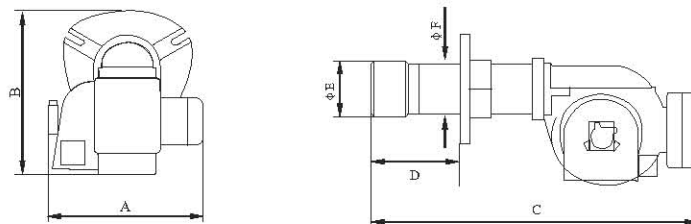

NO.1

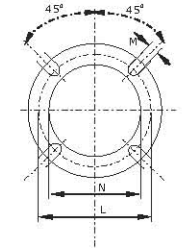

NO.2

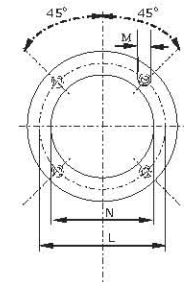

NO.3

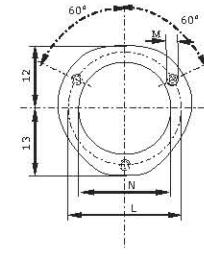

NO.4

www.clover-incinerator.com

型号 Model	宽 Width mm	高 Height mm	长 Length mm	筒长 Length of flange mm	E Head diameter mm	F Cylinder diameter mm	L 安装孔尺寸 mm The size between the installation holes		N φmm	M	NO.
							最小 min	最大 max			
BT-K10KL	300	230	400	105	90	90	130	155	95	M8	1
BT-M8SL	330	220	220	120	89	89	130	155	95	M8	1
BT-M12SL	330	220	220	140	89	89	130	155	95	M8	1
BT3L	250	217.5	330	90	80	80	135	160	90	M8	1
BT6L	245	270	455	150	90	90	130	155	100	M8	1
BT10L	245	270	480	130	95	95	130	155	100	M8	1
BT14L	360	275	415	110	95	95	130	155	105	M8	2
BT14LW	380	275	415	110	95	95	130	155	130	M8	2
BT18L	360	355	650	117	118	114	170	206	130	M10	2
BT26L	450	355	650	139	135	114	170	206	150	M10	2
BT34L	480	380	740	380	150	135	200	244	165	M12	2
BT35L	450	372.5	780	350	150	135	200	244	165	M12	2
BT40L	525	430	985	305	170	135	200	244	180	M12	2
BT55L	600	500	1170	400	170	135	200	244	180	M12	2
*BT75L	630	510	1200	400	205	160		233	180	M12	3
BT100L	640	525	1295	400	230	195		276	240	M16	3
BT120L	685	610	1400	400	230	195		276	240	M16	3
BT180L	785	650	1645	535	260	220		339	270	M16	3
BT250L	915	780	1665	590	260	220		339	270	M16	3
BT300L	915	840	1860	605	360	275	480	510	380	M20	4
BT350L	1050	920	1960	560	360	275	480	510	380	M20	4

W带防水罩 With waterproof cover

N值为炉膛开口 "N" means the size of the hole on the chamber.

* 当燃烧头"E"值大于"N"值时, 如果该锅炉没有炉门的情况下, 请开大于燃烧头"E"的值, 并且需要增加一块过度安装法兰来联接, 不详细请咨询销售办公室。

When "E" is greater than "N", besides without furnace door on this boiler please open the hole "N" greater than "E" and need one extravagant flange to install the burner.

Contact sell office if need any more details.

◆轻油燃烧器燃料供应参考图例 Light oil burner supply fuel drawing

◆轻油喷嘴流量参数表 Oil nozzle consumption data

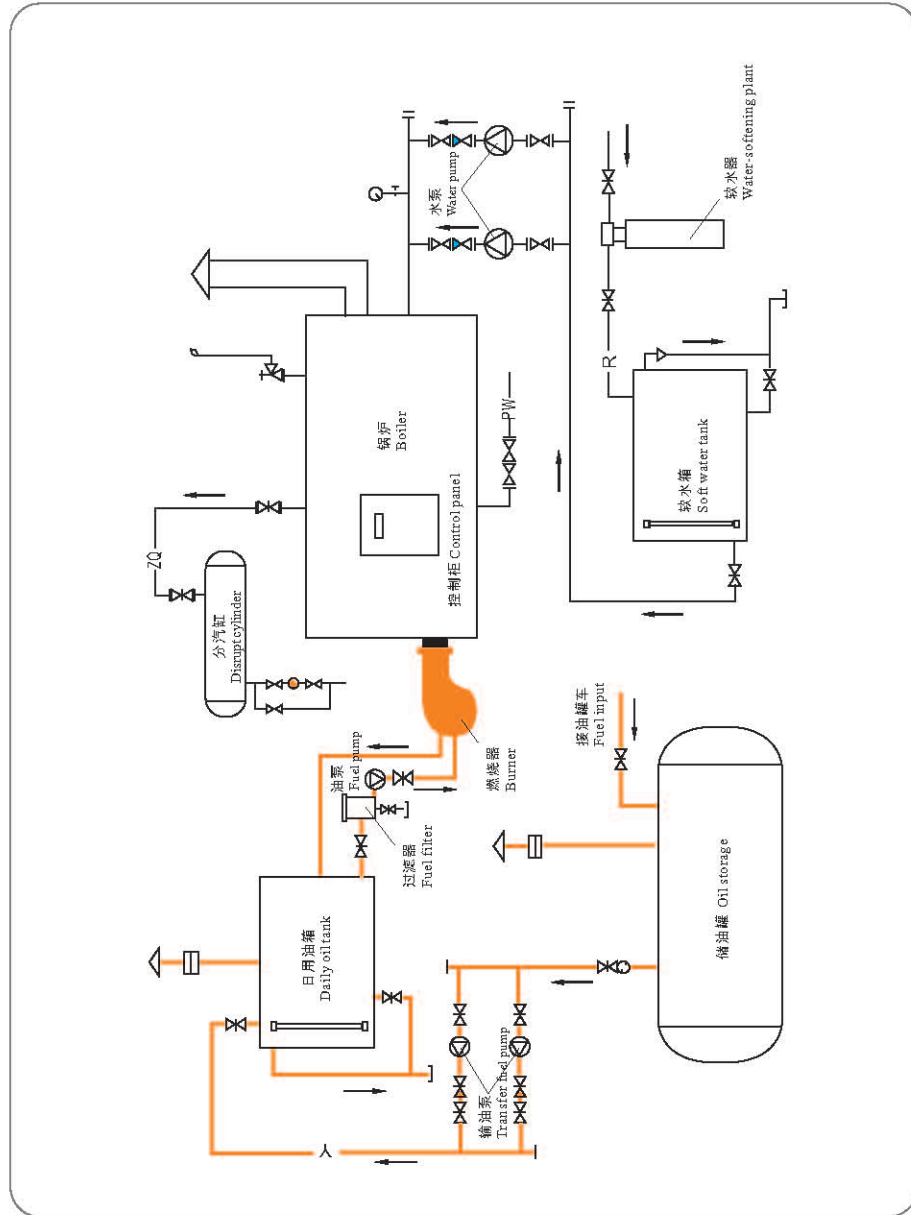

www.clover-incinerator.com

喷嘴 G.P.H.	喷嘴工作压力 kg/cm ²																										喷嘴 G.P.H.
	6	7	8	9	10	11	12	13	14	15	16	17	18	19	20	21	22	23	24	25	26						
0.40	1.18	1.27	1.36	1.44	1.52	1.59	1.67	1.73	1.80	1.86	1.92	1.98	2.04	2.10	2.15	2.20	2.25	2.31	2.36	2.40	2.45	0.40					
0.50	1.47	1.59	1.70	1.80	1.90	1.99	2.08	2.17	2.25	2.33	2.40	2.48	2.55	2.62	2.69	2.75	2.82	2.88	2.94	3.00	3.05	0.50					
0.60	1.77	1.91	2.04	2.16	2.28	2.39	2.50	2.60	2.70	2.79	2.88	2.97	3.06	3.14	3.22	3.30	3.38	3.46	3.53	3.61	3.68	0.60					
0.65	1.91	2.07	2.21	2.34	2.47	2.59	2.71	2.82	2.92	3.03	3.12	3.22	3.31	3.41	3.49	3.58	3.66	3.75	3.83	3.91	3.98	0.65					
0.75	2.20	2.38	2.55	2.70	2.85	2.99	3.12	3.25	3.37	3.49	3.61	3.72	3.82	3.93	4.03	4.13	4.23	4.32	4.42	4.51	4.60	0.75					
0.85	2.50	2.70	2.89	3.06	3.23	3.39	3.54	3.68	3.82	3.96	4.09	4.21	4.33	4.45	4.57	4.68	4.79	4.90	5.00	5.11	5.21	0.85					
1.00	2.94	3.18	3.40	3.61	3.80	3.99	4.16	4.33	4.50	4.65	4.81	4.96	5.10	5.24	5.37	5.51	5.64	5.76	5.89	6.01	6.13	1.00					
1.10	3.24	3.50	3.74	3.97	4.18	4.38	4.58	4.77	4.95	5.12	5.29	5.45	5.61	5.76	5.91	6.06	6.20	6.34	6.48	6.61	6.74	1.10					
1.20	3.53	3.82	4.08	4.33	4.56	4.78	5.00	5.20	5.40	5.59	5.77	5.95	6.12	6.29	6.45	6.61	6.76	6.92	7.07	7.21	7.35	1.20					
1.25	3.68	3.97	4.25	4.50	4.75	5.00	5.20	5.40	5.60	5.80	6.00	6.20	6.35	6.55	6.70	6.85	7.05	7.20	7.35	7.50	7.65	1.25					
1.35	3.97	4.29	4.59	4.87	5.13	5.38	5.62	5.85	6.07	6.28	6.49	6.69	6.88	7.07	7.26	7.44	7.61	7.78	7.95	8.11	8.27	1.35					
1.50	4.42	4.77	5.10	5.41	5.70	5.90	6.24	6.50	6.75	6.98	7.21	7.43	7.65	7.86	8.06	8.26	8.46	8.65	8.83	9.01	9.19	1.50					
1.65	4.86	5.25	5.61	5.95	6.27	6.58	6.87	7.15	7.42	7.68	7.93	8.18	8.41	8.64	8.87	9.09	9.30	9.51	9.71	9.92	10.11	1.65					
1.75	5.15	5.56	5.95	6.31	6.65	6.98	7.29	7.58	7.87	8.15	8.41	8.67	8.92	9.17	9.41	9.64	9.86	10.09	10.30	10.52	10.72	1.75					
2.00	5.89	6.30	6.80	7.21	7.60	7.97	8.33	8.67	8.99	9.31	9.61	9.91	10.20	10.48	10.75	11.01	11.27	11.53	11.78	12.02	12.26	2.00					
2.25	6.62	7.15	7.65	8.15	8.55	8.97	9.37	9.75	10.12	10.47	10.85	11.15	11.47	11.79	12.09	12.39	12.68	12.97	13.25	13.52	13.79	2.25					
2.50	7.36	7.95	8.50	9.01	9.50	9.97	10.41	10.83	11.24	11.64	12.02	12.39	12.75	13.10	13.44	13.77	14.09	14.41	14.72	15.02	15.32	2.50					
3.00	8.83	9.54	10.20	10.82	11.40	11.96	12.49	13.00	13.49	13.96	14.42	14.87	15.30	15.72	16.12	16.52	16.91	17.29	17.66	18.03	18.35	3.00					
3.50	10.30	11.13	11.90	12.62	13.30	13.95	14.57	15.17	15.74	16.29	16.83	17.34	17.85	18.34	18.81	19.28	19.73	20.17	20.61	21.03	21.45	3.50					
4.00	11.77	12.72	13.60	14.42	15.20	15.94	16.65	17.33	17.99	18.62	19.23	19.82	20.40	20.95	21.50	22.03	22.55	23.06	23.55	24.04	24.51	4.00					
4.50	13.25	14.31	15.30	16.22	17.10	17.94	18.73	19.5	20.24	20.95	21.63	22.30	22.95	23.57	24.19	24.78	25.37	25.94	26.49	27.04	27.58	4.50					
5.00	14.72	15.90	17.00	18.03	19.00	19.93	20.82	21.67	22.48	23.27	24.04	24.78	25.49	26.19	26.87	27.54	28.19	28.82	29.44	30.05	30.64	5.00					
5.50	16.19	17.49	18.70	19.83	20.90	21.92	22.90	23.83	24.73	25.60	26.44	27.25	28.04	28.81	29.56	30.29	31.00	31.70	32.38	33.05	33.70	5.50					
6.00	17.66	19.00	20.40	21.63	22.80	23.92	24.98	26.00	26.98	27.93	28.84	29.73	30.59	31.43	32.25	33.04	33.82	34.58	35.33	36.05	36.77	6.00					
6.50	9.13	20.67	22.10	23.44	23.70	25.91	27.06	28.17	29.23	30.26	31.25	32.21	33.14	34.05	34.94	35.80	36.64	37.46	38.27	39.06	39.83	6.50					
7.00	20.60	22.26	23.79	25.24	26.60	27.90	29.14	30.33	31.48	32.58	33.65	34.69	35.69	36.67	37.62	38.55	39.46	40.35	41.21	42.06	42.90	7.00					
7.50	22.07	23.85	25.49	27.04	28.50	29.90	31.22	32.50	33.73	34.91	36.05	37.16	38.24	39.29	40.31	41.31	42.28	43.23	44.16	45.07	45.96	7.50					
8.50	24.43	26.39	28.21	29.93	31.54	33.08	34.55	35.97	37.32	38.63	39.90	41.13	42.32	43.48	44.61	45.71	46.79	47.84	48.87	49.88	50.86	8.50					
9.50	27.96	30.21	32.29	34.25	36.10	37.87	39.55	41.17	42.72	44.22	45.67	47.07	48.44	49.77	51.06	52.32	53.55	54.76	55.93	57.09	58.22	9.50					
10.50	30.90	33.39	35.69	37.86	40.06	41.73	43.74	45.41	47.20	48.90	50.50	52.00	53.50	55.00	56.40	57.80	59.20	60.50	61.80	63.10	64.30	10.50					
12.00	35.32	38.20	40.98	43.30	45.60	47.80	50.00	52.00	54.00	55.90	57.70	59.50	61.20	62.90	64.50	66.10	67.60	69.20	70.70	72.10	73.60	12.00					
13.50	40.62	43.90	46.90	49.80	52.40	55.00	57.50	59.80	62.10	64.20	66.30	68.40	70.40	72.30	74.30	76.00	77.80	79.50	81.30	82.90	84.60	13.50					
15.50	45.03	48.60	52.00	55.20	58.10	61.00	63.70	66.30	68.80	71.10	73.60	75.80	78.00	80.20	82.20	84.30	86.20	88.20	90.10	91.90	93.80	15.50					
17.50	5.51	55.60	59.50	63.10	66.50	69.80	72.90	75.80	78.70	81.50	84.10	86.70	89.20	91.70	94.10	96.40	98.60	100.90	103.00	105.20	107.20	17.50					
19.50	57.40	62.00	66.30	70.30	74.10	77.70	81.20	84.50	87.70	90.80	93.70	96.60	99.40	102.20	104.80	107.40	109.90	112.40	114.80	117.20	119.50	19.50					
21.50	63.20	68.40	73.10	77.50	81.70	85.70	89.50	93.20	96.70	100.10	103.40	106.50	109.60	112.60	115.60	118.40	121.20	123.90	126.60	129.20	131.80	21.50					
24.00	70.64	76.30	81.60	86.50	91.20	95.70	99.90	104.00	107.90	111.70	115.40	118.90	122.40	125.70	129.00	132.20	135.30	138.30	141.30	144.20	147.10	24.00					
2.800	82.41	89.00	95.20	101.00	106.40	111.60	116.60	121.30	125.90	130.30	134.60	138.70	142.80	146.70	150.50	154.20	157.80	161.40	164.90	168.30	171.60	2.800					
30.00	88.30	95.40	102.00	108.20	114.00	119.60	124.90	130.00	134.90	139.60	144.20	148.70	153.00	157.20	161.20	165.20	169.10	172.90	176.60	180.30	183.80	30.00					
G.P.H.	喷嘴出口质量流量 kg/h																										G.P.H.